

General Description

These N-Channel enhancement mode power field effect transistors are using Super Junction technology. This advanced technology has been especially tailored to minimize on-state resistance, provide superior switching performance, and withstand high energy pulse in the avalanche and commutation mode. These devices are well suited for high efficiency switch mode power supply

BVDSS	RDSON	ID
600V	0.38Ω	11A

Features

- 11A,600V, $R_{DS(ON)} = 0.38\Omega @ V_{GS} = 10V$
- Improved dv/dt capability
- Fast switching
- 100% EAS Guaranteed
- Green Device Available

TO252 Pin Configuration

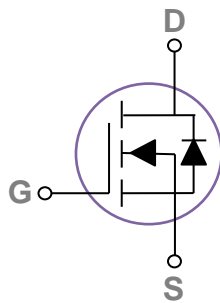
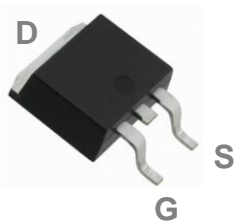

Applications

- High efficient switched mode power supplies
- LED Lighting
- Adapter/charger

Absolute Maximum Ratings (Tc=25°C unless otherwise noted)

Symbol	Parameter	Rating	Units
V _{DS}	Drain-Source Voltage	600	V
V _{GS}	Gate-Source Voltage	±30	V
I _D	Drain Current – Continuous (T _C =25°C)	11	A
	Drain Current – Continuous (T _C =100°C)	7	A
I _{DM}	Drain Current – Pulsed ¹	44	A
EAS	Single Pulse Avalanche Energy ²	57.8	mJ
IAS	Single Pulse Avalanche Current ²	3.4	A
P _D	Power Dissipation (T _C =25°C)	83	W
	Power Dissipation – Derate above 25°C	0.66	W/°C
T _{STG}	Storage Temperature Range	-55 to 150	°C
T _J	Operating Junction Temperature Range	-55 to 150	°C

Thermal Characteristics

Symbol	Parameter	Typ.	Max.	Unit
R _{θJA}	Thermal Resistance Junction to ambient	---	62	°C/W
R _{θJC}	Thermal Resistance Junction to Case	---	1.5	°C/W

Electrical Characteristics (T_J=25 °C, unless otherwise noted)
Off Characteristics

Symbol	Parameter	Conditions	Min.	Typ.	Max.	Unit
BV _{DSS}	Drain-Source Breakdown Voltage	V _{GS} =0V, I _D =250uA	600	---	---	V
ΔBV _{DSS} /ΔT _J	BV _{DSS} Temperature Coefficient	Reference to 25°C, I _D =1mA	---	0.52	---	V/°C
I _{DSS}	Drain-Source Leakage Current	V _{DS} =600V, V _{GS} =0V, T _J =25°C	---	---	1	uA
I _{GSS}	Gate-Source Leakage Current	V _{GS} =±30V, V _{DS} =0V	---	---	±100	nA

On Characteristics

R _{DS(ON)}	Static Drain-Source On-Resistance	V _{GS} =10V, I _D =5.5A	---	0.33	0.38	Ω
V _{GS(th)}	Gate Threshold Voltage	V _{GS} =V _{DS} , I _D =250uA	2	3.4	4	V
ΔV _{GS(th)}	V _{GS(th)} Temperature Coefficient		---	-8.7	---	mV/°C

Dynamic and switching Characteristics

Q _g	Total Gate Charge ^{2, 3}	V _{DS} =480V, V _{GS} =10V, I _D =11A	---	13	---	nC
Q _{gs}	Gate-Source Charge ^{2, 3}		---	3.6	---	
Q _{gd}	Gate-Drain Charge ^{2, 3}		---	5.6	---	
T _{d(on)}	Turn-On Delay Time ^{2, 3}	V _{DD} =380V, V _{GS} =10V, R _G =25Ω I _D =11A	---	26	---	ns
T _r	Rise Time ^{2, 3}		---	28.3	---	
T _{d(off)}	Turn-Off Delay Time ^{2, 3}		---	34	---	
T _f	Fall Time ^{2, 3}		---	33.2	---	
C _{iss}	Input Capacitance	V _{DS} =50V, V _{GS} =0V, F=1MHz	---	690	---	pF
C _{oss}	Output Capacitance		---	57	---	
C _{rss}	Reverse Transfer Capacitance		---	2.47	---	

Drain-Source Diode Characteristics and Maximum Ratings

Symbol	Parameter	Conditions	Min.	Typ.	Max.	Unit
I _S	Continuous Source Current	V _G =V _D =0V, Force Current	---	---	11	A
I _{SM}	Pulsed Source Current		---	---	22	A
V _{SD}	Diode Forward Voltage	V _{GS} =0V, I _S =11A, T _J =25°C	---	---	1.3	V
t _{rr}	Reverse Recovery Time ²	V _{GS} =0V, I _S =11A, dI/dt=100A/μs, T _J =25°C	---	266	---	ns
Q _{rr}	Reverse Recovery Charge ²		---	2.8	---	uC
I _{rrm}	Peak reverse recovery current		---	19.6	---	A

Note :

1. Repetitive Rating : Pulsed width limited by maximum junction temperature.
2. V_{DD}=50V, V_{GS}=10V, L=10mH, I_{AS}=3.4A., R_G=25Ω, Starting T_J=25°C.
3. The data tested by pulsed, pulse width ≤ 300us, duty cycle ≤ 2%.
4. Essentially independent of operating temperature.

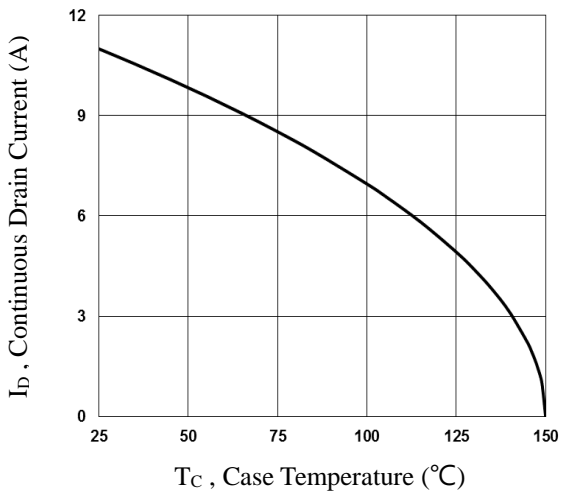

Fig.1 Continuous Drain Current vs. Tc

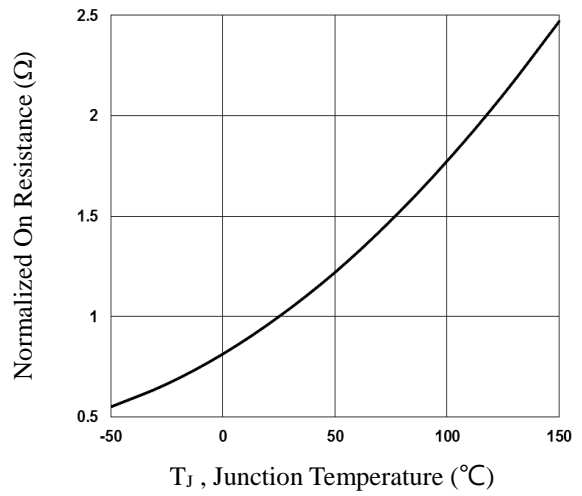

Fig.2 Normalized RDS(on) vs. Tj

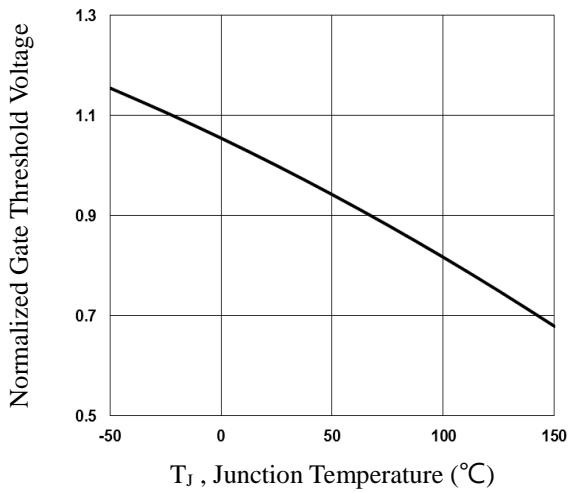

Fig.3 Normalized Vth vs. Tj

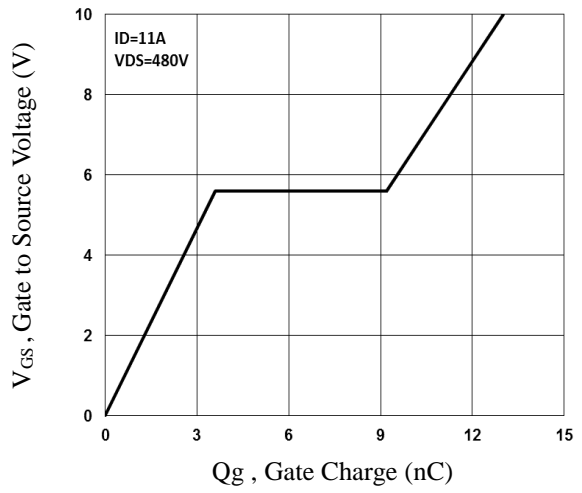

Fig.4 Gate Charge Waveform

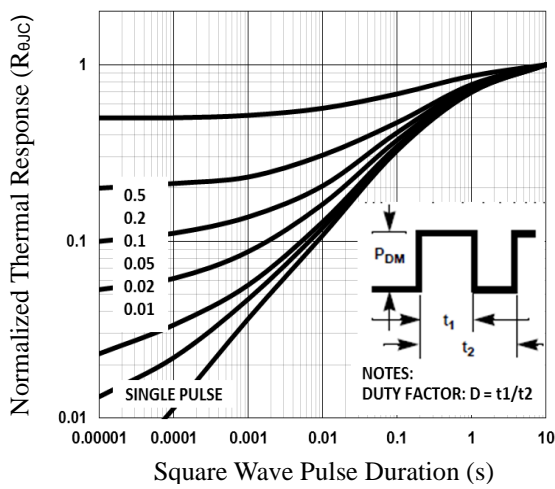

Fig.5 Normalized Transient Impedance

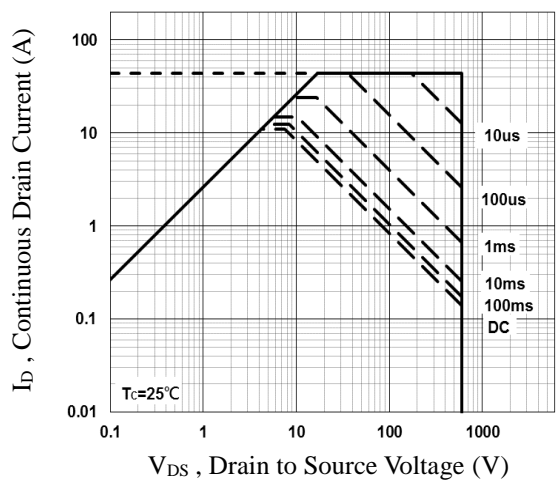
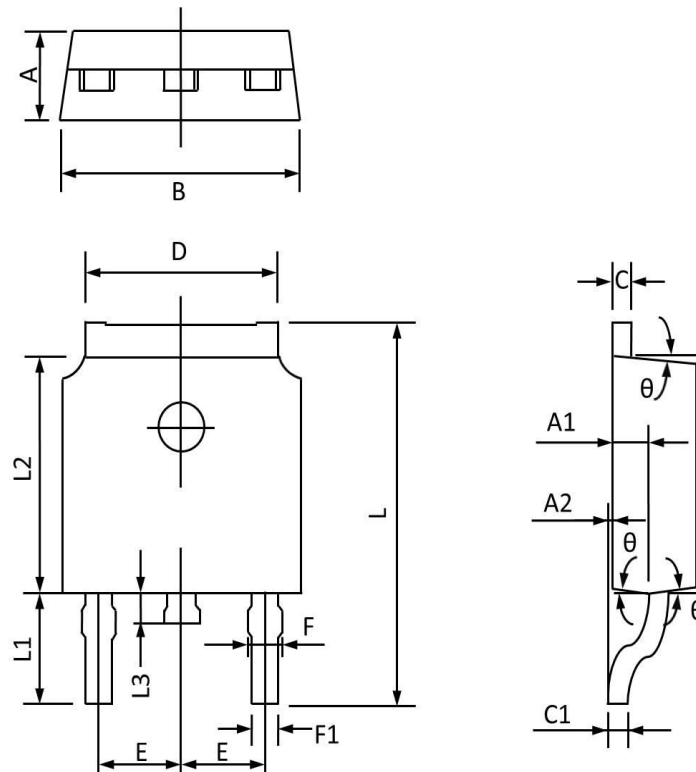

Fig.6 Maximum Safe Operation Area

TO252 PACKAGE INFORMATION



Symbol	Dimensions In Millimeters		Dimensions In Inches	
	MAX	MIN	MAX	MIN
A	2.400	2.200	0.094	0.087
A1	1.110	0.910	0.044	0.036
A2	0.150	0.000	0.006	0.000
B	6.800	6.400	0.268	0.252
C	0.580	0.450	0.023	0.018
C1	0.580	0.460	0.023	0.018
D	5.500	5.100	0.217	0.201
E	2.386	2.186	0.094	0.086
F	0.940	0.600	0.037	0.024
F1	0.860	0.500	0.034	0.020
L	10.400	9.400	0.409	0.370
L1	3.000	2.400	0.118	0.094
L2	6.200	5.400	0.244	0.213
L3	1.200	0.600	0.047	0.024
θ	9°	3°	9°	3°